

Item no.: 17.03.1116

## ROLINE Single Heavy-Duty Gas Spring Monitor Arm, black

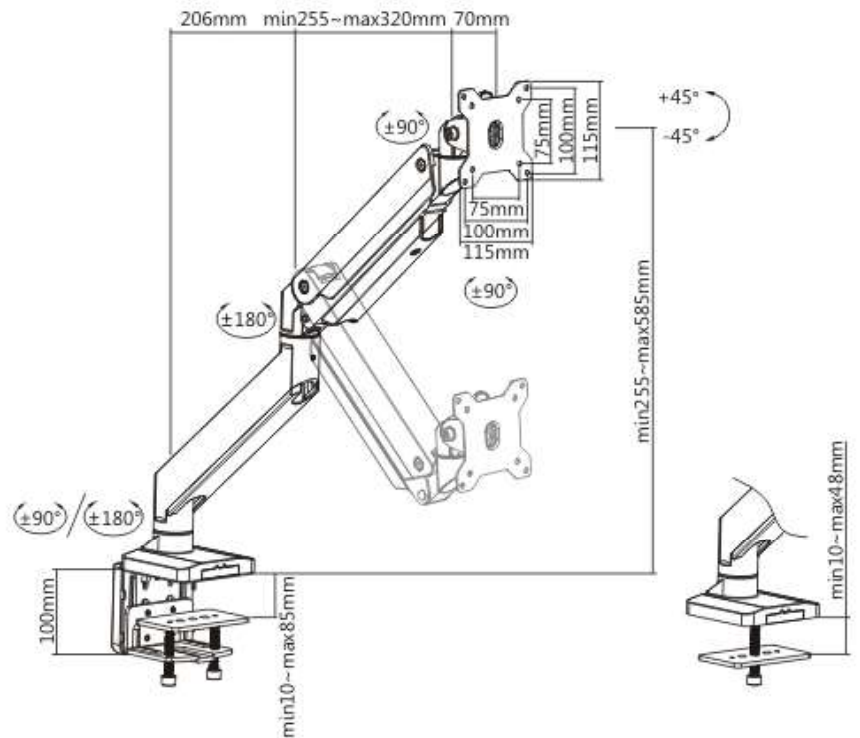

### Features:

- Gas Spring perfectly counterbalances the weight of your monitor
- Slide-in VESA Plate for quick attachment and detachment
- Cable Management keeps everything organized
- Material: aluminum, plastic, steel
- Two Mounting Options: desk clamp and grommet
- Suggested Screen Size: 17" (43.18 cm) to 49" (124.46 cm)
- Monitor Weight Capacity: for flat screen (per screen): 1~18 kg; for Curved Screen (per screen): 1~14kg
- Meets VESA 75 x 75 mm, 100 x 100 mm
- Tilt Range: +45° ~ -45°; Swivel Range: +90° ~ -90°; Screen Rotation: +90° ~ -90°
- Arm Full Extension: 526 mm
- Suggested Desktop Thickness: Clamp: 10 ~ 85 mm; Grommet: 10 ~ 48 mm