

CONNECT 120 REVERSE ARGB

MANUAL

BELIEVE IT

www.Antec.com

All rights reserved. Specifications are subject to change without prior notice. Actual products and accessories may differ from illustrations. Omissions and printing errors excepted. Content of delivery might differ in different countries or areas. Some trademarks may be claimed as the property of others.

V2.2

©1986 – 2024 Antec Inc. All rights reserved.

1 CONTENTS

120MM FAN

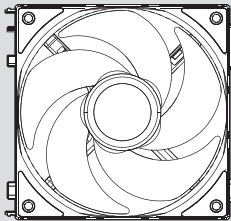

4-PIN PWM & 3-PIN ARGB CABLE

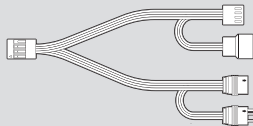

FAN COVER

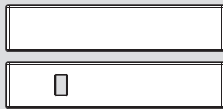

FAN SCREW



RADIATOR SCREW

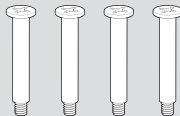

2 FAN INTRODUCTION

*Reverse Fan

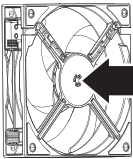

AIR-IN

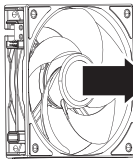

AIR-OUT

3 FAN DIMENSIONS

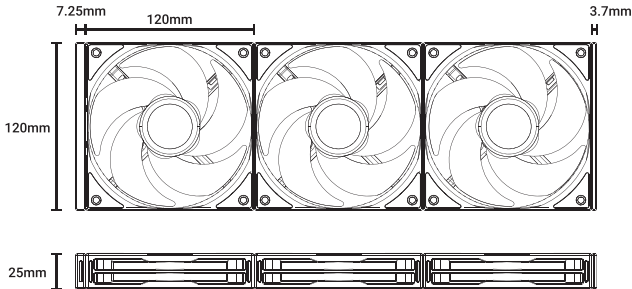

4 FAN INSTALLATION

- Connect the fans

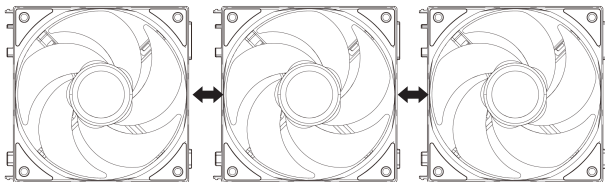

- Install fan covers

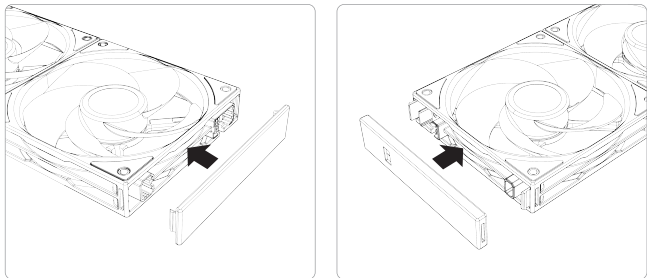

- Install on the chassis with less screws

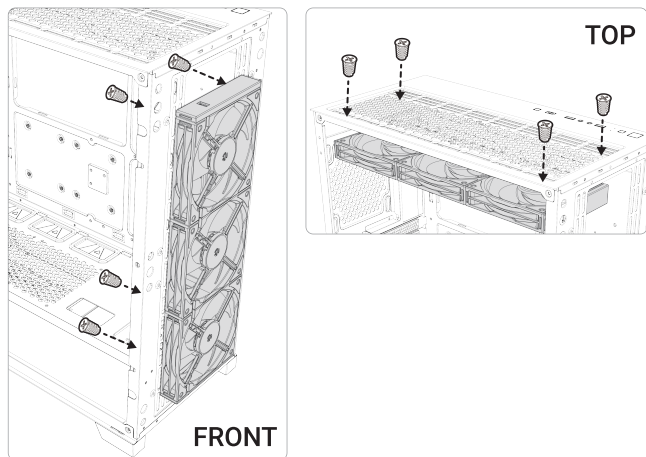

- Install on the radiator with less screws

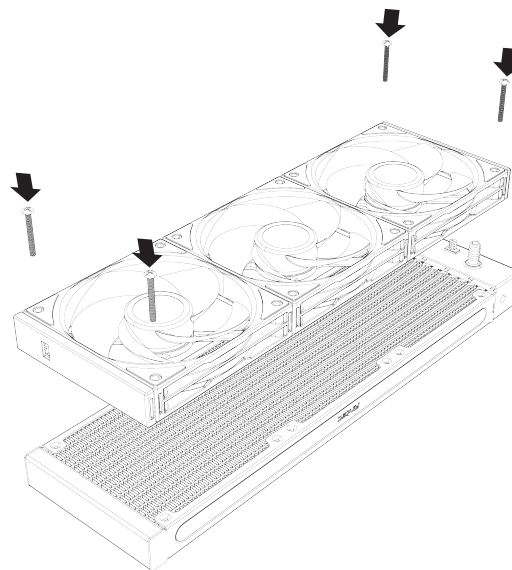

5 FAN CONNECTION

- Connect the cable

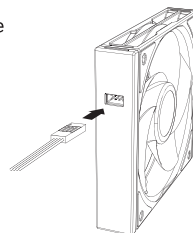

- Connect to the motherboard

