

ROLINE Cat.6 (Class E) Keystone Jack SLIM, RJ-45, UTP, tool-free, black

Product No.	26.11.0375
Manufacturer	ROLINE
Manufacturer No.	26.11.0375
EAN (single piece)	7611990110971

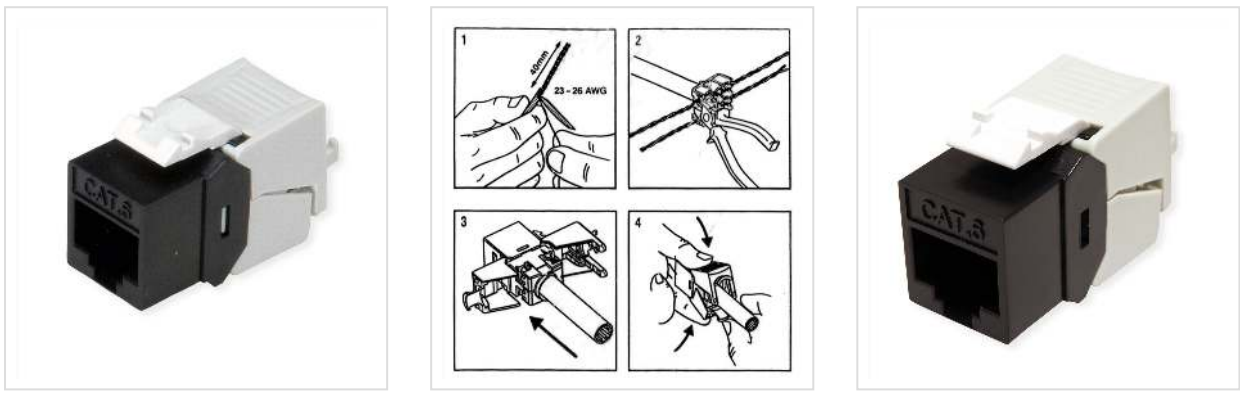

- The system is composed of a 19" patch panel frame and the UTP Cat.6 RJ-45 keystone jacks
- Assembling of cables and keystones takes place toolless
- Colour code on the keystone jacks, based on the standard EIA/TIA 568 A and 568 B
- Colour: Black

For a structured unshielded Cat.6 cabling system we recommend to use the following components:

- ROLINE Cat.6 UTP Cable, Solid Wire, AWG23: 21.15.0990 (100 m), 21.15.0991 (300 m)
- Flush Mount Wall Jack for Keystones, unloaded: 25.16.8579
- ROLINE Cat.6 Keystone, RJ-45, unshielded: 26.11.0352 (black), 26.11.0353 (white)
- 19" Keystone Patch Panel, 24 Ports, unshielded: 26.11.0356 (light grey), 26.11.0357 (black)
- ROLINE Cat.6 UTP Patch Cord, grey, 5 m: 21.15.0935

Our in-house laboratory has tested this cable-plug combination, in a Channel of 100 meters, in compliance with Class E specifications.

Technical specifications	
Manufacturer	ROLINE
Product group	Connection technology TP
Product type	RJ45 Keystone Jack

Colour	black
Shield type	Not screened
Transfer quality	Cat6 / Class E
Quantity of ports	1
Assembly cable connection	Krone LSAPlus
Assignment	EIA/TIA 568A & 568B
Modular assembly	yes
Connection direction	Straight
Height	21 mm
Width	12 mm
Depth	36 mm
Weight	6.4 g
Height of packaging (single piece)	20 mm
Width of packaging (single piece)	30 mm
Depth of packaging (single piece)	50 mm
Package weight (single piece)	0.04 kg